

155' CREW BOAT

M/V Mr. Henry



Registration

Owner	Barry Graham Oil Service, LLC
Operator	Barry Graham Oil Service, LLC
Year Built	2003
Place Built	Breaux Brothers Enterprises, Inc.
Flag	USA
Classification	USCG Subchapter T, Aluminum Hull Construction, Passenger (Inspected) Service



Main Characteristics

Length Overall	155 ft
Beam	30 ft
Depth	12.4 ft
Operating Draft	9.83 ft
Light Displacement	148.86 LT
Summer Freeboard	4.67 ft

Capacities

Fuel	17,035 USG
Ballast/Rig Water	25,765 USG
Potable Water	900 USG

Deck Cargo

Tonnage	274 LT
Length	90 ft
Width	25 ft
Clear Deck Area	2,250 ft ²

Tonnage

Gross Registered Tons	98 GT
Net Registered Tons	66 GT

Machinery

Main Engines	4 Cummins KTA 38-M2
Horsepower	5,400 hp
Reduction Gears	4 Twin Disc MG6650
Gear Ratio	2.47.1
Generators	2 Cummins/Onan 6B5.9-D (m) 55kW
Tunnel Bow Thruster	Wesmar 150 hp
Fire Monitor	1,000 gpm
Oily Water Separator	Heli-Sep

Performance

Maximum Speed	27 knots
Cruising Speed	24 knots
Economy Speed	21 knots

Fuel Consumption

Maximum Speed	250 USG/hour
Cruising Speed	225 USG/hour
Economy Speed	190 USG/hour

Accommodations

Crew	4 persons
Maximum Passengers	72 persons
Passenger Area	72 first class seats & 1 head

Electronics & Controls

2 Radars	Magnetic Compass
GPS Positioning Plotter	EPIRB 406 MHZ
SSB Radio	Loudhailer
2 VHF Radios	PA System
AIS Locating	Navtex
Depth Sounder	Boatrac
Chart Plotter	Satellite Telephone

Special Equipment

Life Floats	81 Total Capacity
Life Preservers	76 Adult
Rescue Equipment	Rescue Platform, Ring Buoys
DAVIT	USCG Inspected
Fuel Meter	Liquid Control with Printer
Engine Monitoring	CSP
Search Lights	3 Total
Firefighting	Fixed CO ² System in all Machinery Spaces, Hand Portable & Semi-Portable throughout vessel
Fire Detection	Integrated Smoke & Heat Detection

Corporate Office

Physical Address
12354 Padgett Switch Road
Irvington, Alabama 36544
P: 251.824.2774 F: 251.824.7058

Mailing Address

P.O. Box 982
Bayou La Batre, Alabama 36509

Operations Office

Physical Address
6044-B Railroad Avenue
Morgan City, Louisiana 70380
P: 985.702.9883 F: 985.702.9885

Mailing Address

P.O. Box 3403
Morgan City, Louisiana 70381

This specification is preliminary and subject to change without notice. Exact tank capacities, deadweight, deck cargo capacity and other figures that have been calculated may change when the actual vessel is delivered. As such, these particulars should be taken as indicative and do not constitute warranty. For additional information, please contact Barry Graham Oil Service, LLC at www.bgos.net.

155' CREW BOAT

M/V Mr. Henry

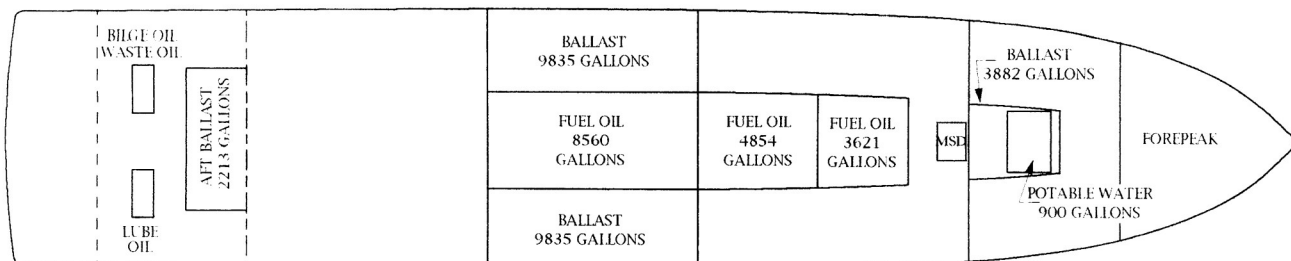

TANK ARRANGEMENT PLAN

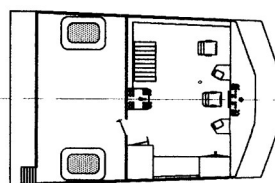

UPPER DECK AND PILOTHOUSE

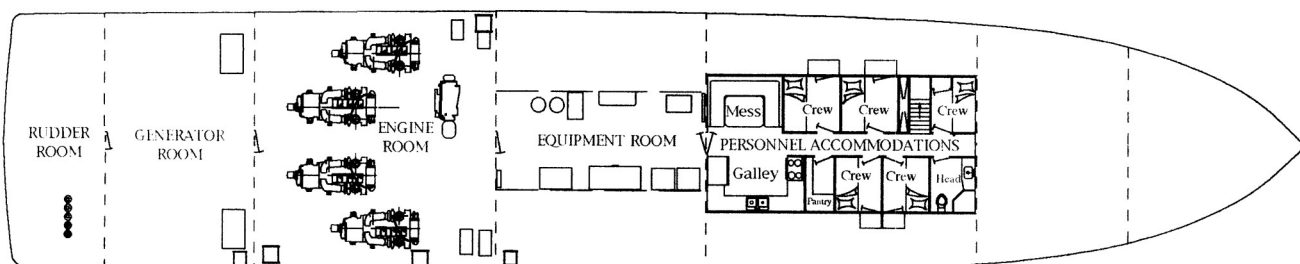

BELOW DECK ARRANGEMENT PLAN

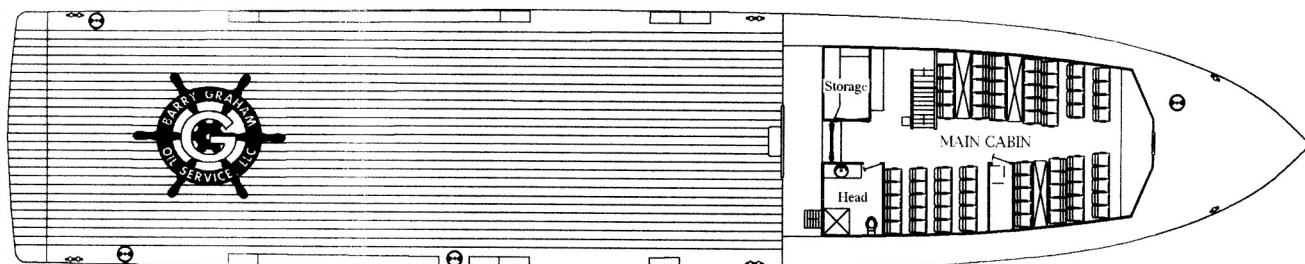

MAIN DECK ARRANGEMENT PLAN

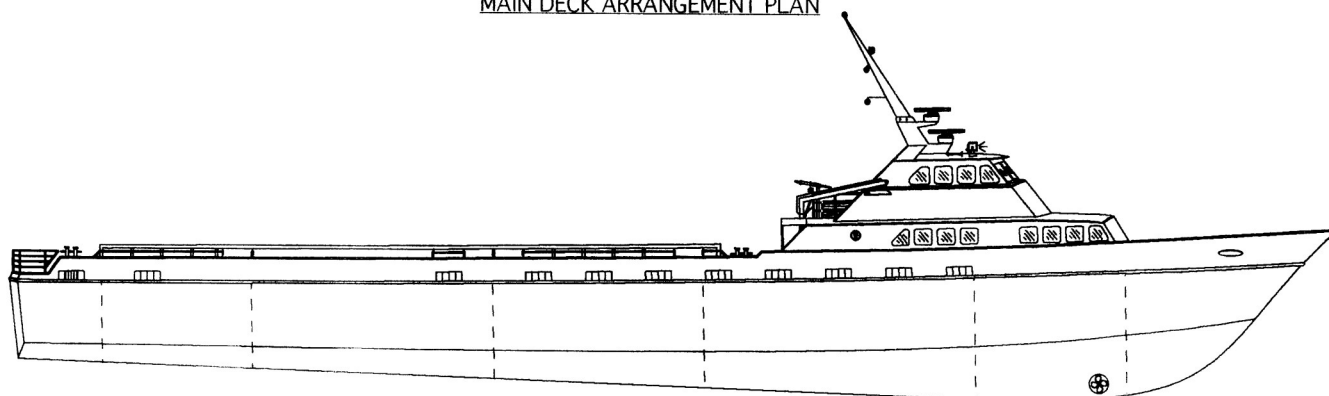

OUTBOARD PROFILE

BARRY GRAHAM OIL SERVICE, L.L.C.

POST OFFICE BOX 982
BAYOU LA BATRE, AL 36509
(251) 824-2774 FAX: (251) 824-7958

155' x 30' x 12.5' CREW/SUPPLY VESSEL